

# *Prajakta* **PARK**

3 BHKD Park Facing Premium Flats in Abhayankar nagar



An Exclusive Collection of 5 Meticulously Designed  
Hand-Sculpted 3 BHK Apartments.



# *Prajakta* PARK

3 BHKD Park Facing Premium Flats in Abhayankar nagar





# Typical Floor Plan

3 BHKD Park Facing Flats

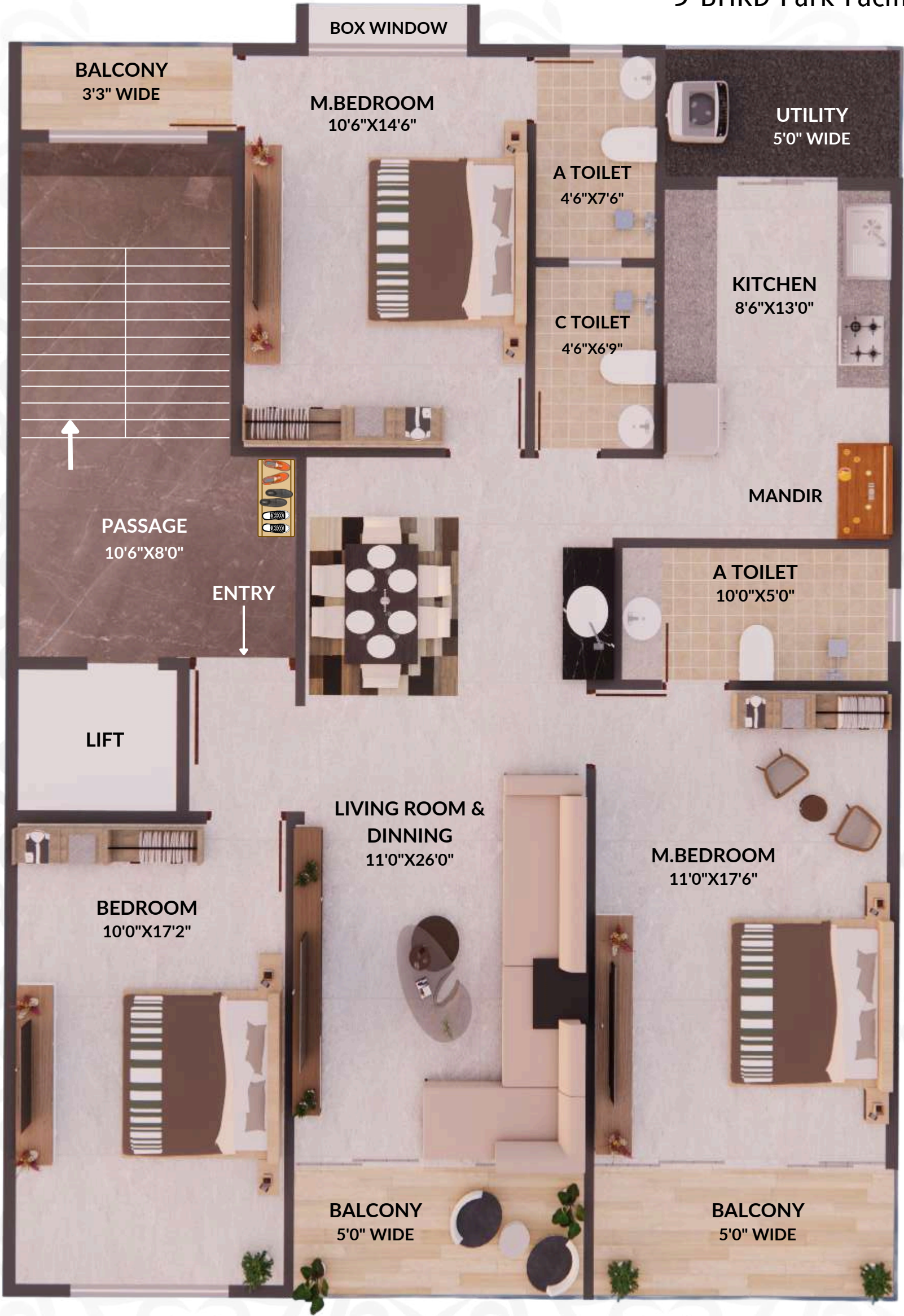

## Area Statement

Apartment No.

101 To 501

RERA  
Carpet Area

104.92 Sq.mtr  
1129 Sq.ft

Usable  
Carpet Area

115.94 Sq.mtr  
1248 Sq.ft

Total Area

1800 Sq.ft

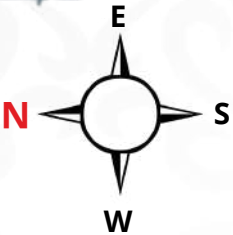

9 M Wide Road

• Asthetically Designed 3 BHK Homes

• 100% Vastu Complaint



# Ground Floor Plan

3 BHKD Park Facing Flats

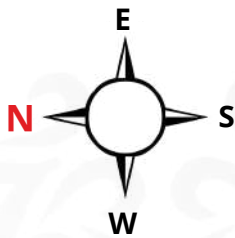
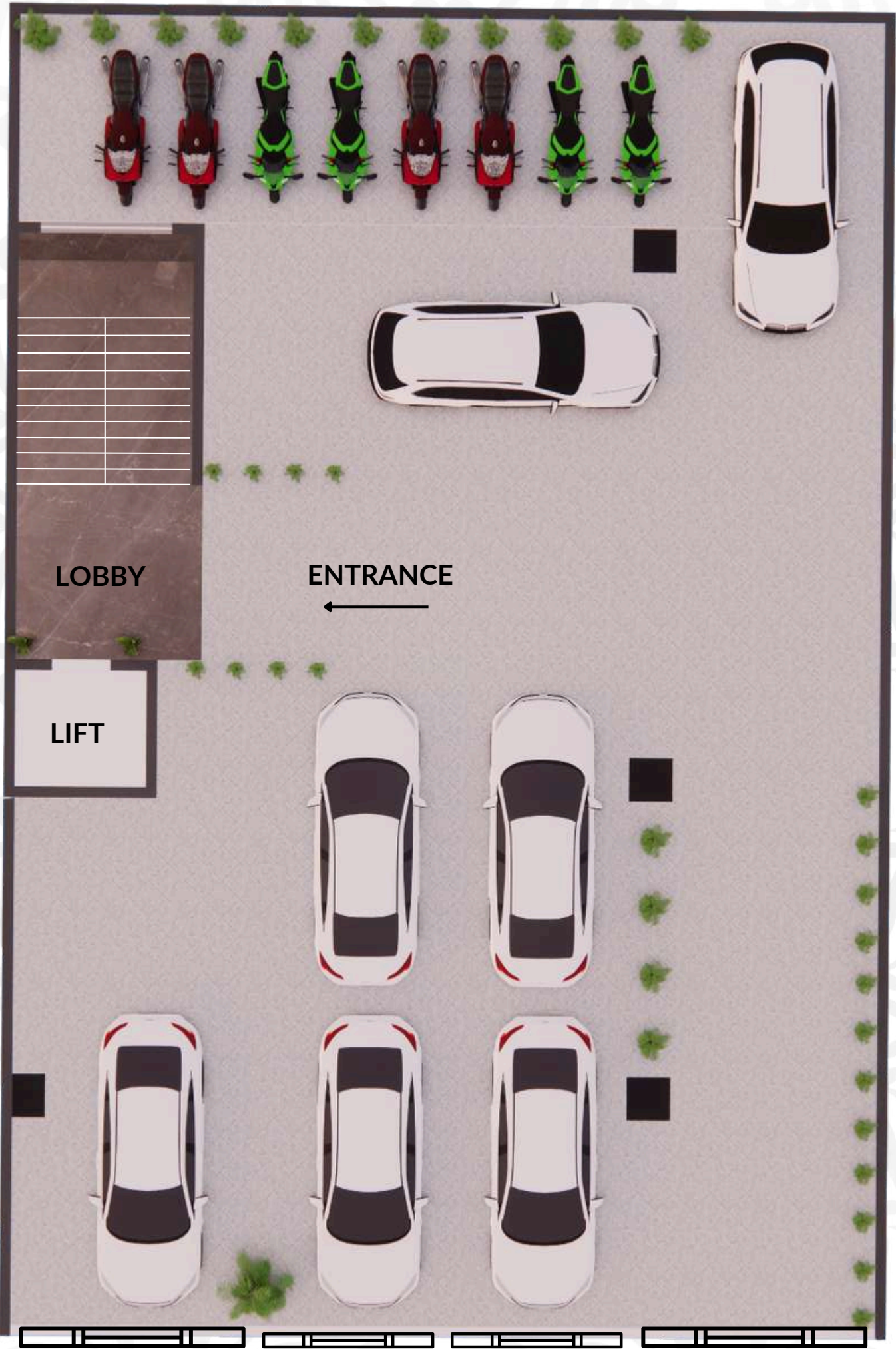

Tentative Parking Plan, Subject to change

9 M Wide Road

- *Smartly Designed Car Parking Area to Ease your Car Park*
- *Maximum Plantation in a margin area to ensure greenery*
- *CCTV cameras throughout parking area*



3 BHKD Park Facing Flats

Prajakta  
PARK



*Gazibo / Party area on Terrace*





3 BHKD Park Facing Flats

*Prajakta*  
**PARK**







*Music / Zumba Room on Terrace*





# Specifications:

	<b>STRUCTURE-</b>	RCC framed
	<b>DOORS -</b>	Main door designer and internal molded/flush doors with laminates on both sides & with box framing to all doors.
	<b>WINDOWS -</b>	UPVC windows with M.S. grills.
	<b>WIRING -</b>	Fully concealed with branded wires such as Polycab or equivalent.
	<b>FLOORING -</b>	Digital vitrified tiles [2' X 4']/ Double charged vitrified tiles [800mm x 800mm] in all of the rooms. Designer ceramic tiles in terraces. Kota stone/tiles in staircase with railing.
	<b>TOILETS -</b>	1 wash basin, 1 WC pan, 1 shower in each toilet. Designer tiles. Jaguar/Cera or Similar make sanitary fittings. Power plugs for geysers.
	<b>WATER SUPPLY-</b>	24 hour water supply from overhead tank. Separate line for drinking and utility water. Plumbing internal piping fully concealed
	<b>PUTTY-</b>	3 Hand Putty with Primer (No Internal Paint)
	<b>POP -</b>	Plain POP in all rooms
	<b>KITCHEN -</b>	Granite Platform with SS Sink

# Features:

- Lift with inverter Back Up.
- Allotted car park to individual flat owners.
- Automatic level water controller to give uninterrupted water supply.
- Branded modular switches.
- Elegant elevation.
- AC points in all the three bed rooms.
- 100% Vastu compliance.



## *Security Features:*

- CCTV Cameras.
- Video Door Phones for individual flats.
- Intercom Connectivity.

## *Special Amenities:*



**Roof Top yoga area.**



**Roof Top Garden / Get together area.**



**Lift direct access to terrace.**



**Designer Entrance lobby on every floor.**



**Roof Top solar generation plant to reduce common electricity bill.**



**Karaoke room for the ultimate entertainment experience!**



# *Prajakta* PARK

3 BHKD Park Facing Flats





Note:

The purchaser has to provide following charges separately.

- M.S.E.B. Meter deposit and substation charges.
- Registration charges and stamp duty as per actual.
- Water Meter deposit charges.
- Extra work charges (will be taken in advance)
- Service tax, GST and any other taxes will be extra
- Maintenance deposit.

Completed Projects:

Award Winning Project in Luxurious Category



PRAJAKTA ROYALE  
Abhyankar Nagar



PRAJAKTA GREENFINITY  
Wanjari Nagar,Nagpur

Winner of 2 Real Estate Award  
1.Ultatech Award 2023  
2.MP Birla Award 2024



PRAJAKTA GREEN SERENITY  
Madhav Nagar,Nagpur



PRAJAKTA IKEBANA  
Bajaj Nagar



SHUBHASHISH SQUARE  
Shraddhanand Peth Sq.



Times Real-Estate Award Winner-2022

Keshav Enclave.	—	Nandanvan	Prajakta Orchid.	—	Pandey Layout
Uttam Apartment	—	Nandanvan	Prajakta Pinnacle	—	Telecom Nagar
Honey Archana Complex	—	Medical Road, Uthkhana	Prajakta Crosswinds	—	Hingna Road
Ashish Annex	—	W.H.C Road, Laxminagar	Prajakta Marigold	—	Bajaj Nagar
Sai Bhushan	—	Swawlambi Nagar	Prajakta Prabhakamal	—	Shankar Nagar
DMA Harmony	—	Balewadi, Pune	Sai Vatika Layout	—	Issasani
Prajakta Gardens	—	Gopal Nagar	Prajakta Classic	—	Abhyankar Nagar



# Location Map:

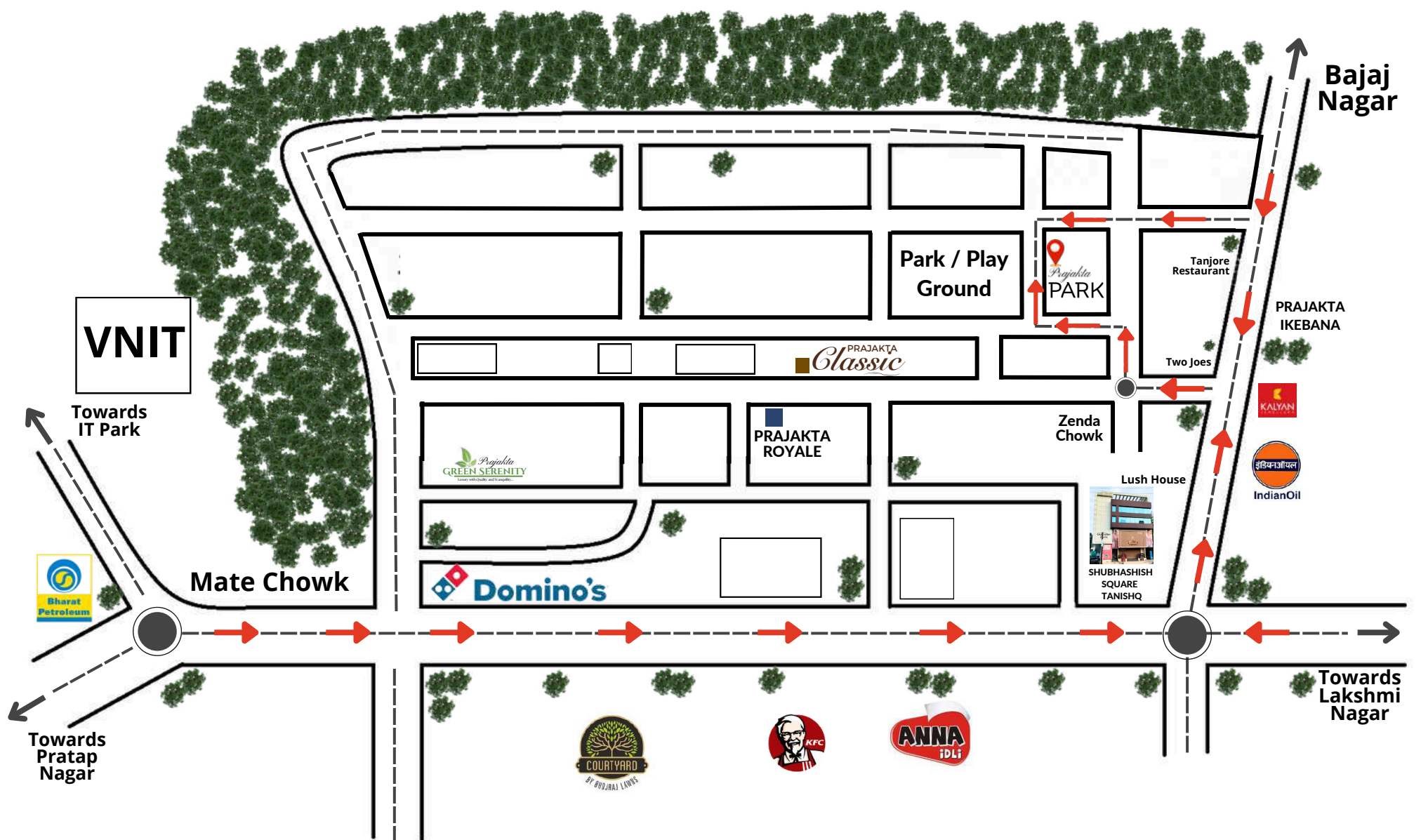

Site Address- Plot No. 176, Behind Hotel Tanjore, in front of ground , Abhyankar Nagar, Nagpur-440010

Contact for More Details - 9822229002 / 7249566026

Project By-



LAXMI NAGAR OFFICE -

**ASHISH ANNEX**

Unit No. 302, Plot No. J-13, Scientific Co-op Society,  
WHC Road, Between Laxmi Nagar & Aathrasta Sq., Laxmi  
Nagar, Nagpur-22

MAHAL OFFICE -

**UMA APARTMENT**

Behind Binzani Book Depot, Tilak  
Road, Mahal, Nagpur-32  
Cell: 9822474211

WEBSITE - [www.ashishconstructions.in](http://www.ashishconstructions.in)

E-MAIL - [aplondhe@yahoo.co.in](mailto:aplondhe@yahoo.co.in)

[info@ashishconstructions.in](mailto:info@ashishconstructions.in)

ARCHITECT - ARYA VERTEX

LEGAL ADVISOR - B. R. Khumkar

DISCLAIMER: The advertisement is purely conceptual. Pictures, Images are for representative purpose only. The designs, dimensions, cost, facilities, plans, specifications, furniture and images are only indicative in nature and are for the purpose of illustration, including a possible layout. The areas, prices elevation and specifications in the Sale Agreement signed between you and Ashish Constructions shall be final and binding. This advertisement does not constitute any form of offer, the purchaser is governed by T&C of the sale agreement. Booking is subject to confirmation and acceptance of T&Cs.